



**NIRMAL TRINITY  
TOWER**



**2, 2.5 & 3 BHK LUXURIOUS FLATS & PENTHOUSES**

**A TOWER THAT RISES ABOVE ALL ELSE**  
Your home, Our Responsibility! A Symphony Of Peaceful Living!



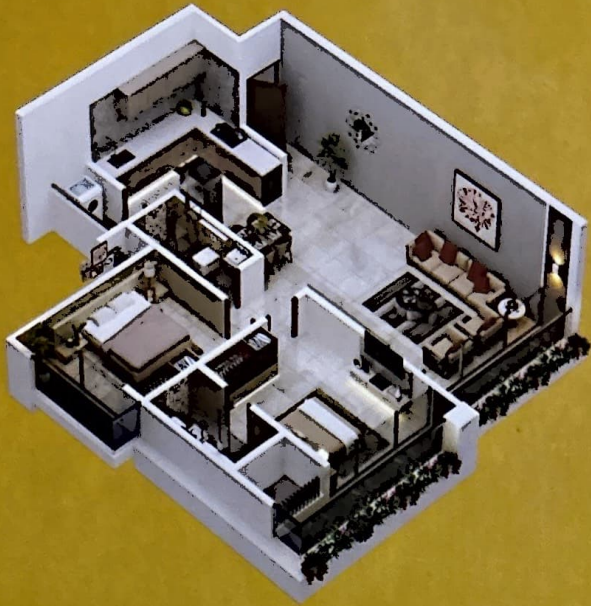

### T-6 TOWER 2 BHK ISOMETRIC VIEW

TOP VIEW

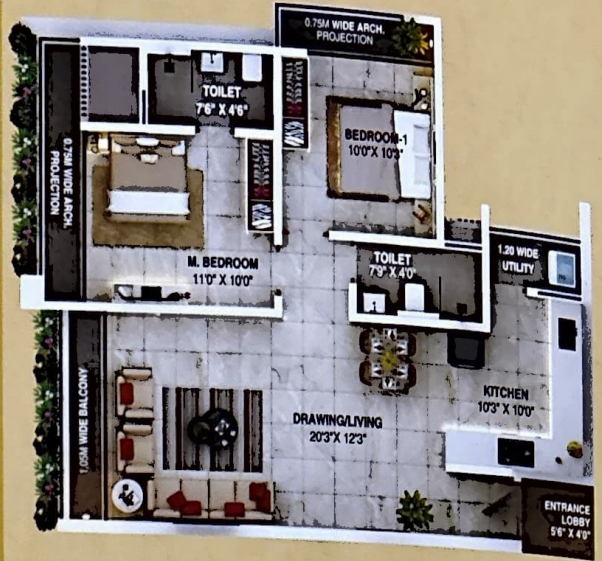

### T-7 TOWER 2.5 BHK ISOMETRIC VIEW



TOP VIEW



### T-4 TOWER 3 BHK ISOMETRIC VIEW

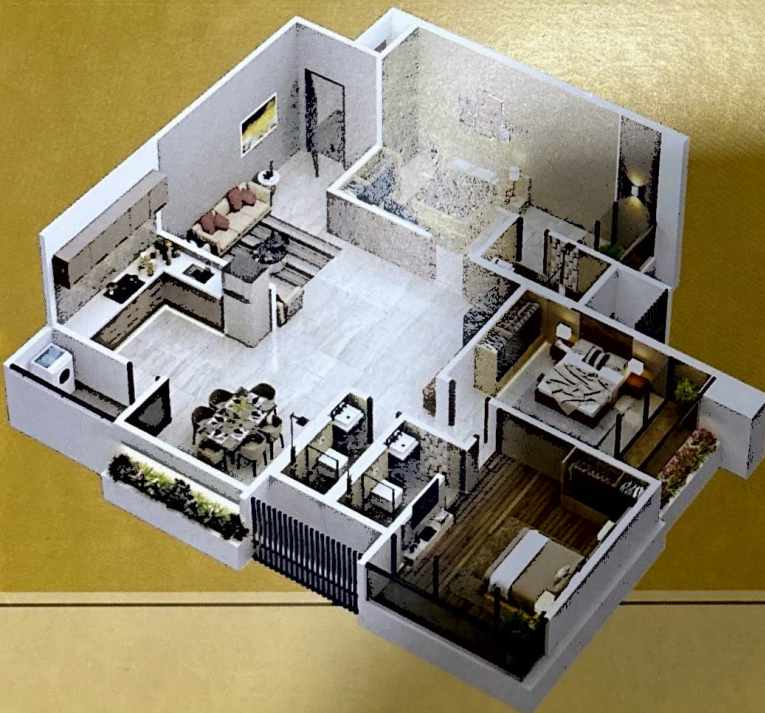

TOP VIEW





## 4 BHK PENTHOUSE ISOMETRIC VIEW



### AREA STATEMENT



SR.NO.	TOWER NAME	P-LINE/B-UP AREA IN SQ.FT.	TOTAL NO. OF FLATS	FLOORS
0 1	T 4 - 3 BHK	1389	100	26 TH FLOOR
	T 4 - 4 BHK	1689	02	27 TH FLOOR
		<b>TOTAL</b>	<b>102</b>	
0 2	T 5 - 2 BHK	926	146	26 TH FLOOR
		1120	02	
		1108		
		<b>TOTAL</b>	<b>148</b>	
0 3	T 6 - 2 BHK	926	146	26 TH FLOOR
		1120	02	
		1108		
		<b>TOTAL</b>	<b>148</b>	
0 4	T 7 - 2.5 BHK	1154	92	25 TH FLOOR
		1432	02	25 TH FLOOR
		<b>TOTAL</b>	<b>94</b>	

### SPECIFICATIONS

#### Structure :

- RCC framed structure.
- External & common wall : 4" Internal wall
- Thick Fly Ash Break / AAC

#### Painting :

- External wall - Weather Shield, Internal wall Emulsion paint,
- Railing/Grill - Synthetic Enamel paint

#### Flooring :

- Vitrified tiles flooring
- Anti-Skid Ceramic tiles for Balconies & Utilities

#### Doors & Windows :

- Teak wood frame flush shutter veneer finish for Main Door & laminate finish for internal Doors
- UPVC Windows
- Water proof laminate with Granite frame for Toilets

#### Kitchen :

- Ceramic tiles, stainless steel Sink

#### Electrical :

- 100% DG power back up for common Area & essential services
- Geyser, washing machine, Refrigerator, Microwave points in Kitchen & Utilities
- TV & telephone points in master bedroom & living area
- One AC point in 2 BHK, 2.5 BHK, units & Two points in 3 BHK units.

#### Toilets:

- Coloured glazed wall tiles.
- White wall mounted EWC, Counter type wash basin, chrome plated hot & cold mixture with OH shower, Pillar cock, Health Faucet, Concealed stop cock under standard make.

#### Others :

- Compound wall & CCTV coverage, around premises
- Elevator : One 8 passengers lift, fire lift, Stretcher lift, of standard make.





# LOCATION MAP

A Project by



**NUCC**  
NIRMAL UJJWAL CREDIT  
CO-OPRETIVE SOCIETY LTD.,  
NAGPUR (MULTI-STATE)

ESTD. 1989

OFFICE ADDRESS : 193, Nandanvan main Road,  
Nagpur - 440 009 Ph. : 0712-2740800  
e-mail : nucc@nirmalujjwal.com  
website : www.nirmalujjwal.com

SITE ADDRESS



**NIRMAL TRINITY**  
T O W E R

SITE ADDRESS : Nirmal Trinity Tower,  
Near HP Gas Godown, Chitnis Nagar, Near old  
Nirmal Nagari, Mouza Harpur, Umred Road, Nagpur.

BOOKING CONTACT :

**8600765389**  
**8600765390**  
**8600765380**

ARCHITECT



**AR. HARISH CHANDANI**

STRUCTURAL CONSULTANTS



**AAJ ENGINEERS AND  
CONSULTANTS PVT. LTD.**

LEGAL ADVISER

**Hariramani Associates**  
(Advocate)  
**Adv. Jayesh Hariramani**



**MAHARERA REG. NO.**  
**P50500076597**

NOTE

- 1) Provided all electrical / electronic equipment and machine, wirings warranty by manufacturing company terms and condition.
- 2) Provided all CP fittings warranty by manufacturing company terms and condition.
- 3) Provided Lifts, door fitting and window fitting locks warranty by manufacturing company terms and condition.

Disclaimer: This brochure is purely conceptual & not a legal offering. The plans, specifications, images & other details herein are indicative, furniture & accessories will not be provided by the developer & the developer/owner reserves all the rights to change. All dimensions mentioned in the drawings may vary / differ due to construction contingencies & site conditions. All dimensions are shown from unfinished surfaces. The printed material does not constitute an offer of any type between the developer / owner & the recipient. Any purchase / lease of this development shall be governed by terms & conditions of agreement for sale / lease entered into between parties & no details mentioned in this printed material shall in any way to govern such transaction.